

- ### KEY NOTES
- 1 REMOVE PARTITION FINISH, BASE, FRAMING, FIRE BLOCKING, AND ASSOCIATED SUPPORT TO UNDERSIDE OF FLOOR DECK ABOVE.
 - 2 REMOVE SUSPENSION, TILE, AND LIGHT FIXTURES FROM CEILING IN CORRIDOR.
 - 3 REMOVE FINISH AND/OR FURRING ON EXISTING CMU WALLS TO UNDERSIDE OF FLOOR DECK ABOVE.
 - 4 REMOVE VINYL TILE AND THRESHOLDS AT FLOOR IN CORRIDOR.

- ### GENERAL NOTES
1. PROTECT EXPOSED FIREPROOFING ON STEEL COLUMNS DURING CONSTRUCTION. PROTECT ALL FINISHES AND EQUIPMENT TO REMAIN AND BE USED IN NEW PLAN.
 2. PROTECT FLOOR, CEILING, DOORS, AND PARTITIONS TO REMAIN ALONG CORRIDOR WALLS AFTER DEMOLITION.
 3. SAW CUT CONCRETE SLAB AS NECESSARY FOR INSTALLATION OF NEW WASTE LINES BELOW SLAB. INFILL CUTS WITH CONCRETE AFTER WASTE LINE INSTALLATION.
 4. REMOVE CERAMIC TILE FLOORING AND SETTING BED, AND ABANDONED WASTE & VENT PIPING REMAINING IN AREAS TO RECEIVE NEW APARTMENTS.

The Phoenix Apartments
Interior Alterations

5802 Annapolis Road
Bladensburg, Maryland 20710

NOVITSKE ARCHITECTS

201 North Fairfax Street • Suite 33
Alexandria VA 22314
703 535 7899 • 703 535 8840 fax

I CERTIFY THAT THESE DOCUMENTS WERE PREPARED BY OR APPROVED BY ME AND THAT I AM A DULY LICENSED ARCHITECT UNDER THE LAWS OF THE STATE OF MARYLAND, LICENSE NUMBER 0013269, EXPIRATION DATE SEPT 27, 2016.

1 BASEMENT DEMOLITION PLAN - EAST
A201 SCALE: 1/8"=1'-0" NORTH

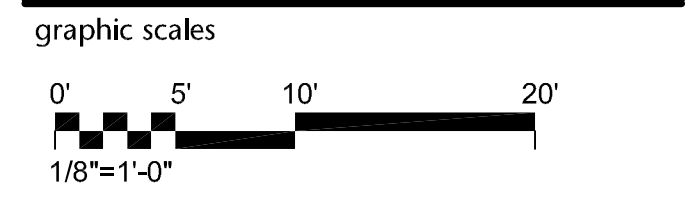
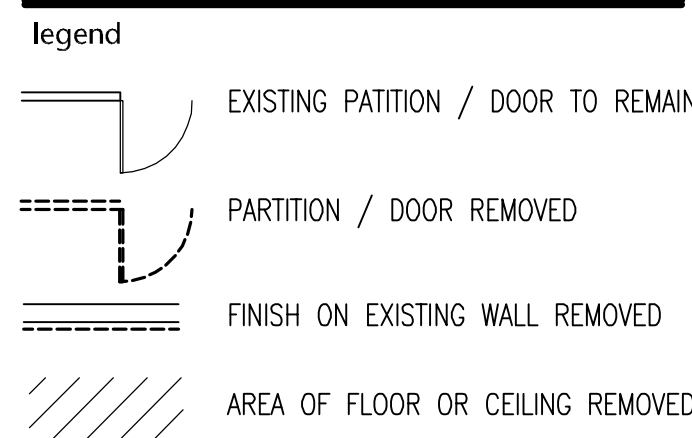
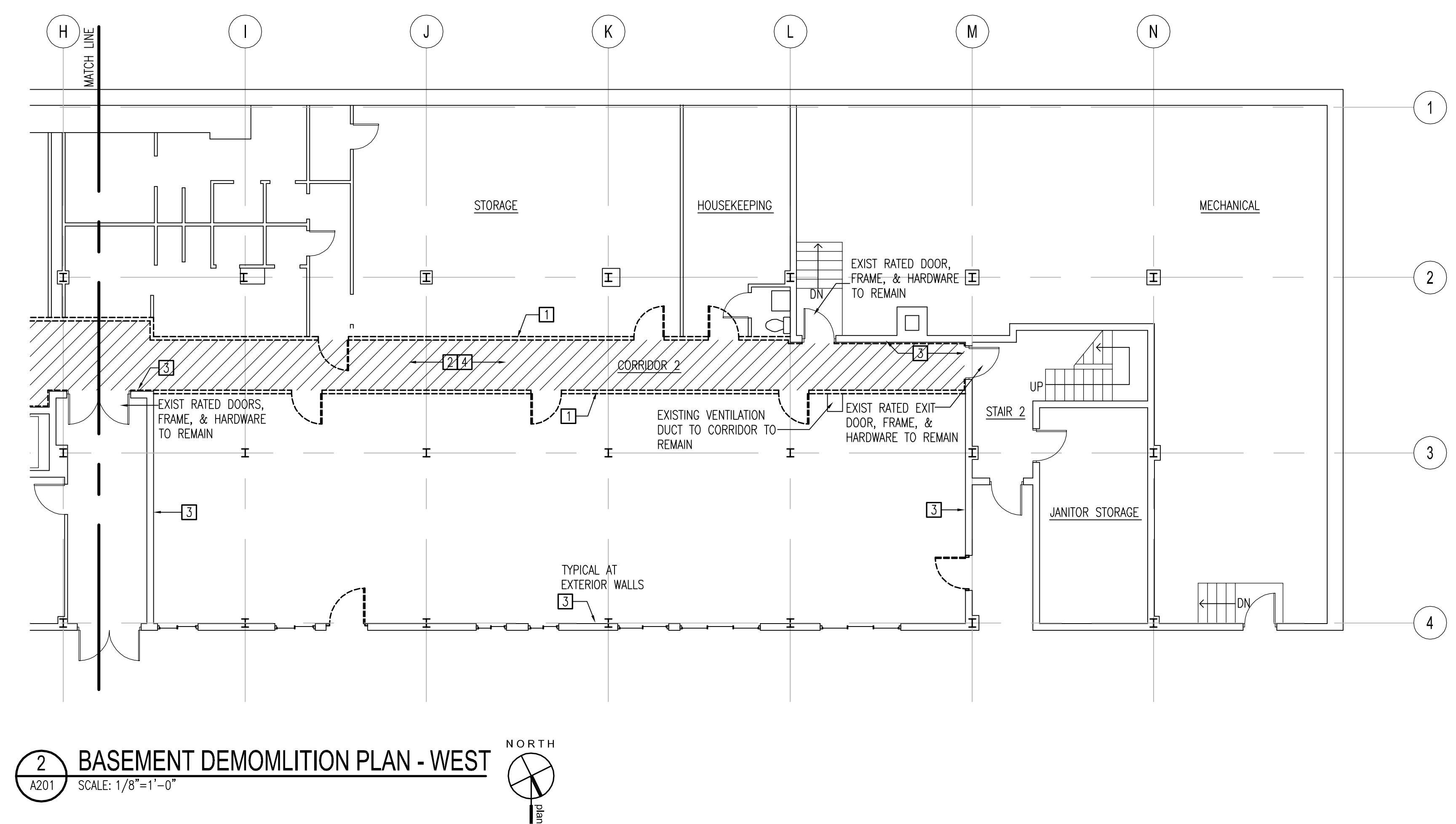

2 BASEMENT DEMOLITION PLAN - WEST
A201 SCALE: 1/8"=1'-0" NORTH

project: 21413
phase: Permit
date: 16 February 2015
revisions:

Building 5802
Demolition Plan

A201